



Features:

- CABINET CONSTRUCTION
 - Exterior - coated steel
 - Interior - attractive, aluminum liner with stainless steel floor
- Rounded corner design inside of the cabinet makes it easy to clean the inside storage room
- Self-closing double pane glass door with positive seal, torsion type closure system
- R290 Refrigeration system holds 33°F to 41°F (0°C to 5°C)
- Adjustable temperature set point and defrost frequency
- Adjustable, heavy duty PVC coated shelves
- LED light
- "No stoop" lower shelf
- Easily accessible condenser coil for cleaning, and easy service access
- Simple installation with no plumbing required

Warranty

- Two year parts and labour; Five years on compressor.



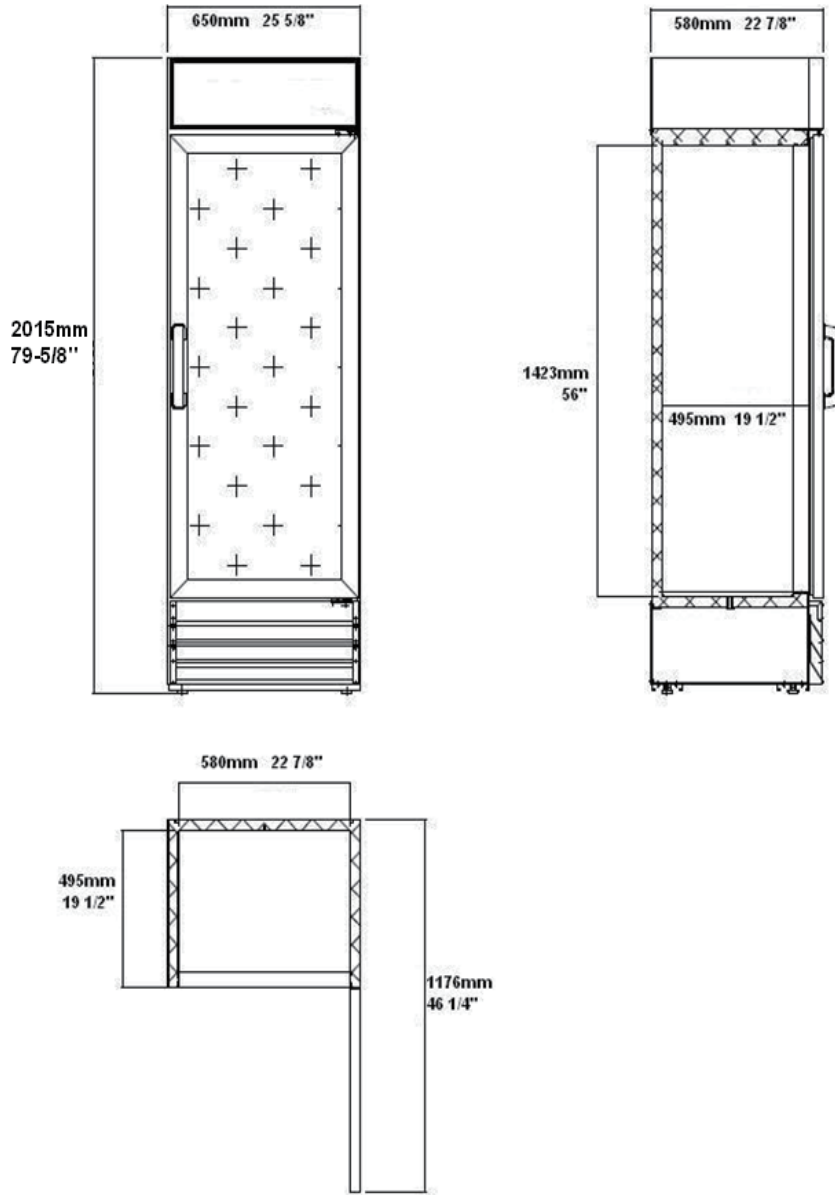

| Model | Doors | Shelves | Dimension (mm) (inch) | | | HP | Voltage | Amps | Capacity (L) (Cu Ft.) | Net Weight (KG) (LBS) | Temperature Range | NEMA Config. |
|------------|-------|---------|-----------------------------|------|------|-----|----------|------|-----------------------------|-----------------------------|----------------------|-----------------|
| | | | L | D | H | | | | | | | |
| C1-25GDVCX | 1 | 4 | 650 | 580 | 2015 | 1/4 | 115/60/1 | 2.88 | 398 | 120 | 0 ~ 5°C | 5-15P ⓘ |
| | | | 25.6 | 22.8 | 79.3 | | | | 14 | 265 | 33 ~ 41°F | |

Specifications subject to change without notice.